

## INSTALLATION INSTRUCTIONS FOR FIREBOX LINER KITS FOR USE WITH FIREPLACE MODELS LISTED IN TABLE 1

### PACKAGING LIST

- 1 ea. Left Side Panel
- 1 ea. Right Side Panel
- 1 ea. Rear Panel
- Metal screws (for use with porcelain panels only)
- 1 ea. Installation Instructions.

### TOOLS / SUPPLIES NEEDED

- Safety Glasses
- Protective Work Gloves
- Phillips Head Screwdriver
- Power Drill, and 5/16" Hex Bit Tool

Firebox Liner Kits		
Cat. No.	Model	Description
F1886	ABLK33V	<b>Vintage Red Stacked 33</b> - Aries33, Gemini33, DRT3033
F1825	ABLK35V	<b>Vintage Red Stacked 35</b> - Aries35, Gemini35, Scorpio35, DRT3035, DRT3535
F1826	ABLK40V	<b>Vintage Red Stacked 40</b> - Aries40, Gemini40, Scorpio40, DRT3040, DRT3540
F1888	ABLK45V	<b>Vintage Red Stacked 45</b> - Aries45, Gemini45, Scorpio45, DRT3045, DRT3545
F1887	MBLK33B	<b>Buff Brick Stacked 33</b> - Aries33, Gemini33, DRT2033
F1827	MBLK35B	<b>Buff Brick Stacked 35</b> - Aries35, Gemini35, Scorpio35, DRT2035, DRT3035, DRT3535, Aurora35, Madison35,
F1828	MBLK40B	<b>Buff Brick Stacked 40</b> - Aries40, Gemini40, Scorpio40, DRT2040, DRT3040, DRT3540, Aurora40, Madison40,
F1889	MBLK45B	<b>Buff Brick Stacked 45</b> - Aries45, Gemini45, Scorpio45, DRT2045, DRT3045, DRT3545, Aurora45, Madison45
F2187	BLK330TR-H	<b>Old Town Red Herringbone 33</b> - Gemini33, DRT3033
F2188	BLK350TR-H	<b>Old Town Red Herringbone 35</b> - Gemini35, Scorpio35, DRT3035, DRT3535, Aurora35, Madison35
F2189	BLK400TR-H	<b>Old Town Red Herringbone 40</b> - Gemini40, Scorpio40, DRT3040, DRT3540, Aurora40, Madison40
F2190	BLK450TR-H	<b>Old Town Red Herringbone 45</b> - Gemini45, Scorpio45, DRT3045, DRT3545, Aurora45, Madison45
F2224	BLKBP-35	<b>Black Reflective Porcelain 35</b> - Scorpio35, DRT3535, Aurora35
F2225	BLKBP-40	<b>Black Reflective Porcelain 40</b> - Scorpio40, DRT3540, Aurora40
F2226	BLKBP-45	<b>Black Reflective Porcelain 45</b> - Scorpio45, DRT3545, Aurora45

**Table 1**

### GENERAL INFORMATION

This document contains installation instructions for firebox liner kits for use with models listed in **Table 1**. Ceramic panels are fragile; use care to prevent breakage when handling the panels.

**Do NOT** install the firebox liner kit until the fireplace has been completely installed, the gas line has been connected and tested for leaks, and the burner operation has been verified.

**READ ALL THE STEPS BEFORE STARTING THE INSTALLATION THE FIREPLACE MUST BE OFF AND COLD BEFORE BEGINNING.**

**ALL WARNINGS, PRECAUTIONS AND INSTRUCTIONS IN THE INSTALLATION AND OPERATION MANUAL PROVIDED WITH THE APPLIANCE APPLY TO THESE INSTRUCTIONS.**

If you encounter any problems, need clarification of these instructions or are not qualified to properly install this kit, contact your local distributor or dealer.

If any of these parts are missing or damaged, contact your dealer or IHP.us.com for referral information.

**IMPORTANT NOTE:** Do not force the panels. Excessive force may cause breakage. If the panels are correctly positioned, they will fit snugly in place.

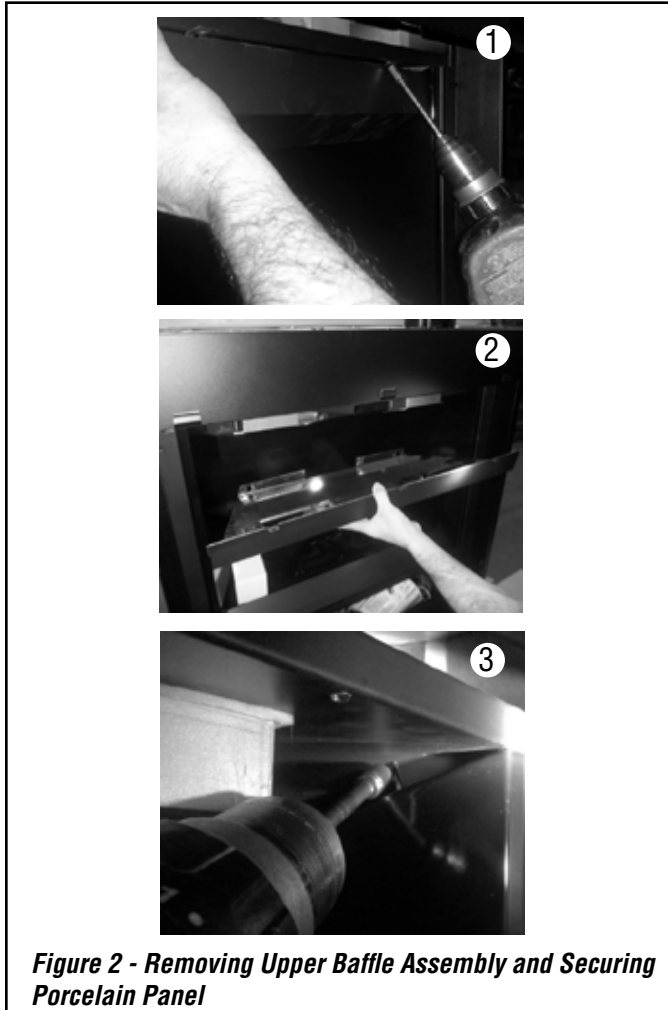
### INSTALLATION INSTRUCTIONS

1. Follow the procedure "Turning Off Gas To Unit", located on the Lighting Instructions pullout labels in the control compartment of the unit and in the Installation Instructions provided with the appliance.
2. Remove barrier screen per instructions in the Installation and Operation Instructions manual provided with appliance.
3. Remove glass door per instructions in the Installation and Operation Instructions manual provided with appliance.
4. **Aries™ and DRT/DRC2000 models only** - Remove the lintel by removing three screws (*see Figure 1*).

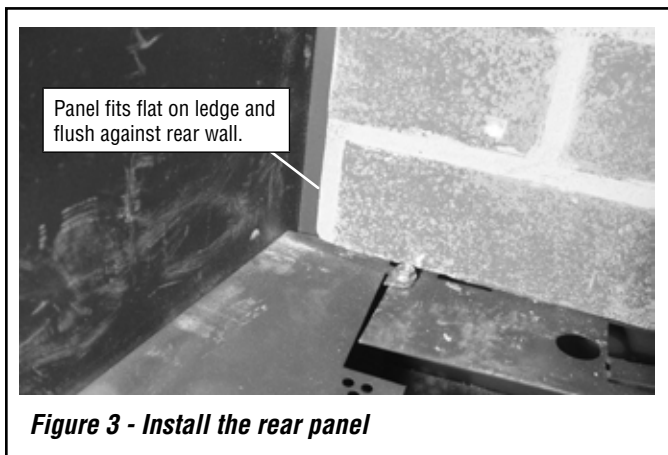


**Figure 1 - Remove the lintel (specified models only)**

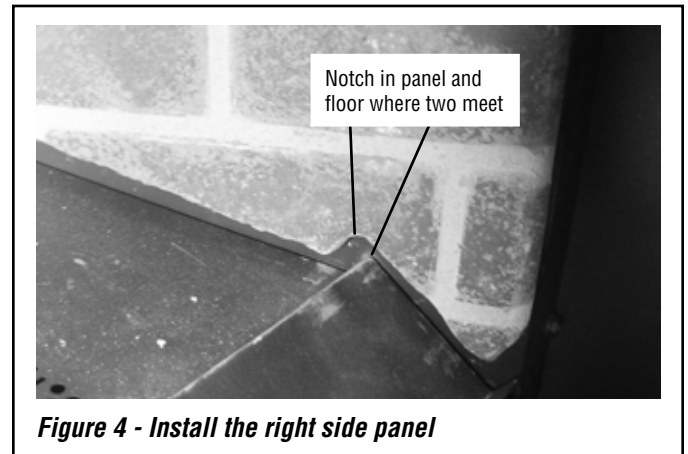
5. If installing **Porcelain Firebox Liner Kits** - Remove upper baffle assembly (see **Figure 2**, details 1 and 2).



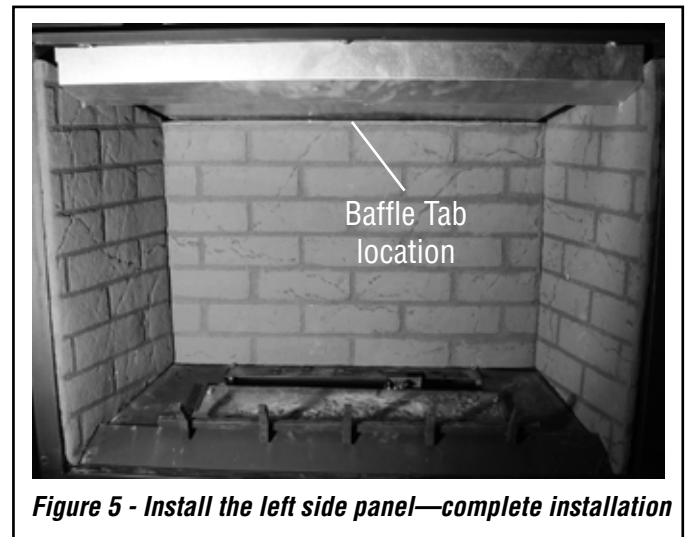
6. Carefully remove the log set from the firebox.  
7. Remove the three (3) firebox liner panels from the packing materials.  
8. Carefully position the rear panel, upper edge first, with base on ledge in the firebox against the rear wall (**Figure 3**).



**NOTE:** When installing panels, ensure that the tab at the back of the baffle is completely removed (see **Figure 5**) for proper operation.



9. While holding the rear panel, carefully slide the right side panel into the firebox (**Figure 4**).  
10. Carefully slide the left side panel into the firebox (**Figure 5**).  
11. For porcelain panels, secure to unit sides with metal screws (see **Figure 2**, detail 3).



11. Reinstall the lintel or baffle assembly, if applicable.  
12. Carefully reinstall the log set, glass door, and barrier screen. Refer to the instructions in the Installation and Operation manual included with the appliance.

NOTE: DIAGRAMS & ILLUSTRATIONS ARE NOT TO SCALE.

IHP reserves the right to make changes at any time, without notice, in design, materials, specifications, and prices, and also to discontinue colors, styles, and products. Consult your local distributor for fireplace code information.