

Fuel Conversion Instructions

Natural Gas to Propane/LP

For Models:
LPK-ODFORTG-36

Kit Contents:

Description	Qty.	Size
Front Burner Orifice	2	#56
Middle Burner Orifice	1	#50
Pilot Orifice	1	#16
LP Gas Valve Regulator	1	
LP Conversion Rating Plate Label	1	

Tools required: Torx T20 Safety Driver, Small Flathead Screwdriver, 7/16", 1/2", 9/16" and 3/4" Combination Wrenches, Philips Screwdriver

This Kit Must be Installed by a Qualified Service Agency

Check to make sure that you have received all of the correct parts. If not, contact your dealer before beginning conversion.

CAUTION

Before installing conversion kit...

- Disconnect electrical power.
- Shut off gas supply.
- Allow unit to cool.

WARNING

This conversion kit shall be installed by a qualified service agency in accordance with the manufacturer's instructions and all applicable code and requirements of the authority having jurisdiction. If the information in these instructions is not followed exactly, a fire, explosion or production of carbon monoxide may result causing property damage, personal injury or loss of life. The qualified service agency is responsible for the proper installation of this kit. The installation is not proper and complete until operation of the converted appliance is checked as specified in the manufacturer's instructions supplied with the kit.

LOGS MAY BE HOT TO THE TOUCH. HANDLE THE LOGS WITH GLOVES AND PLACE THEM ON A NONCOMBUSTIBLE SURFACE WHEN THEY HAVE BEEN REMOVED FROM THE INSERT.

FOR YOUR SAFETY

Do not store or use gasoline or other flammable vapors and liquids in the vicinity of this or any other appliance.

Conversion Instructions - Natural Gas to Propane/LP (Conversion instructions are from control side of fireplace)

1. Remove the barrier screen located in front of the glass by lifting up and out.
2. Remove the glass door assembly by releasing the three (3) latches. Tilt the glass door assembly away from the unit and pull it out of the track.
3. Check on the right side behind the access door on the rating plate to make sure you have a model ODFORTG-36.
4. Remove the logs, brick and glowing embers.
5. Unfasten the four (4) screws that secure the two (2) grates to the burner assemblies and pull out of unit. *Figure 1*

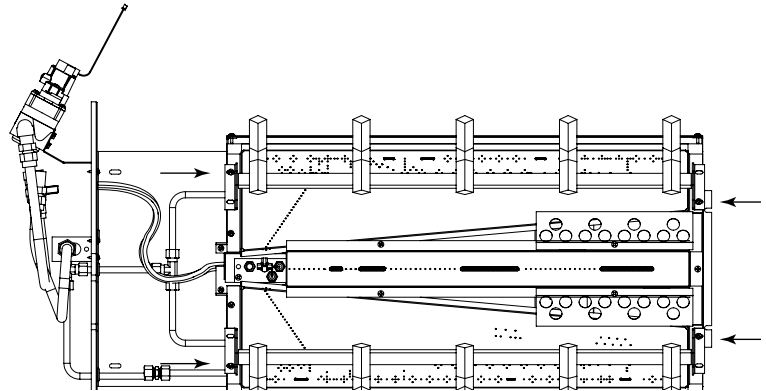

**Figure 1 -
Remove Screws**

6. Remove the remaining five (5) screws securing the middle and front burners to the engine base. *Figure 2*
7. Using two (2) open-ended wrenches (1/2" and 9/16"), loosen the fittings for the middle and front burners at the locations shown in *Figure 2*.
8. Loosen fitting at each orifice and remove the tubes from each venturi.
9. Remove the air shutter from the middle burner venturi and discard. *Figure 3* The two (2) front burner air shutters do not need to be adjusted, leave at 1/4" open.
10. Replace all three (3) orifices with those provided in the conversion kit. Do not tighten against venturi all the way. Leave a 1/32-1/16" gap between orifice hex and venturi body.
11. Unfasten the pilot from the pilot bracket. Lift up the pilot. Using a 7/16" open wrench, unscrew the fitting at the bottom of the pilot and replace pilot orifice with the one provided with the kit.

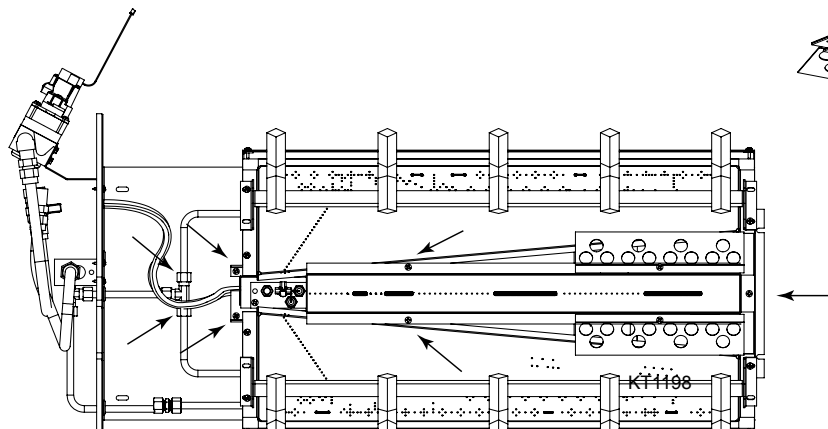
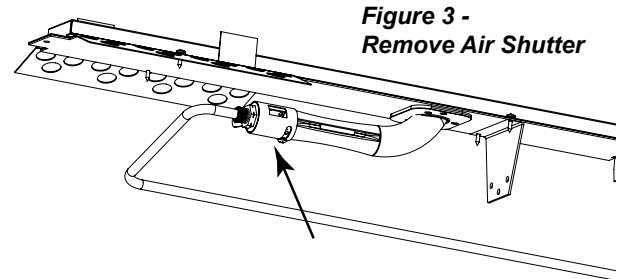

Figure 2

Retighten the fitting and secure the pilot and the shield using the two screws removed earlier.

12. Reinstall middle, rear burner and grate in reverse order of removal.
13. Unfasten the two (2) screws that secure the valve assembly and black ground wire to the side of the firebox. Bring valve forward. *Figure 5*. Disconnect the stepper motor wiring harness from the control box and the green wire from the regulator.
14. Using a Torx T20 Safety driver, remove and discard the regulator and rubber gasket in the face of the valve. *Figure 6*
15. Install the new regulator with rubber gasket from the conversion kit. Make sure the gasket is seated properly.



**Figure 3 -
Remove Air Shutter**



Figure 4

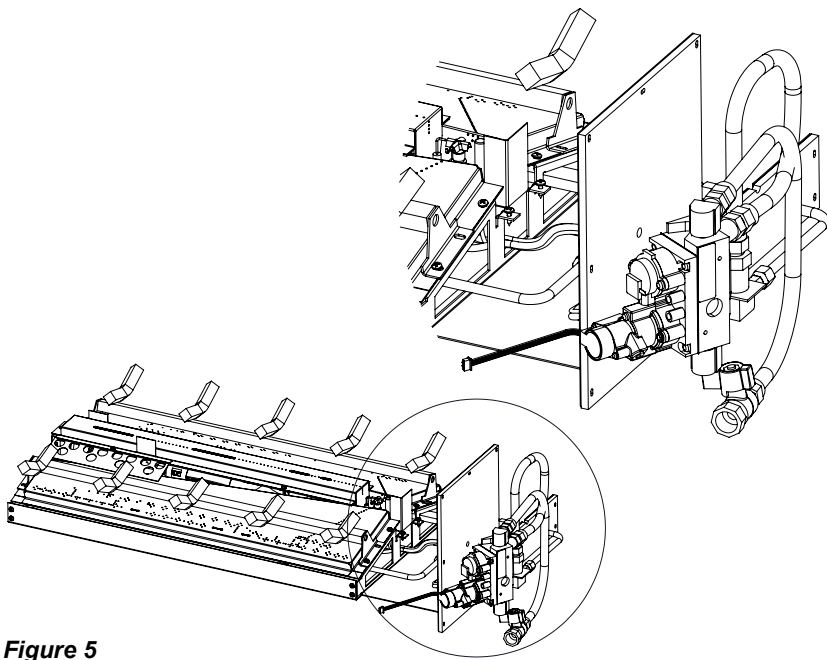

Figure 5

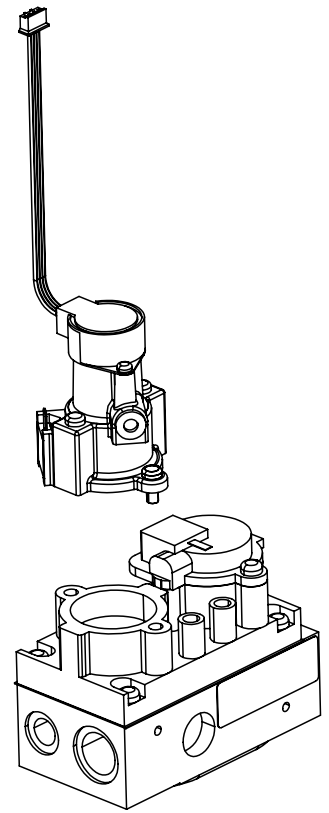

Figure 6

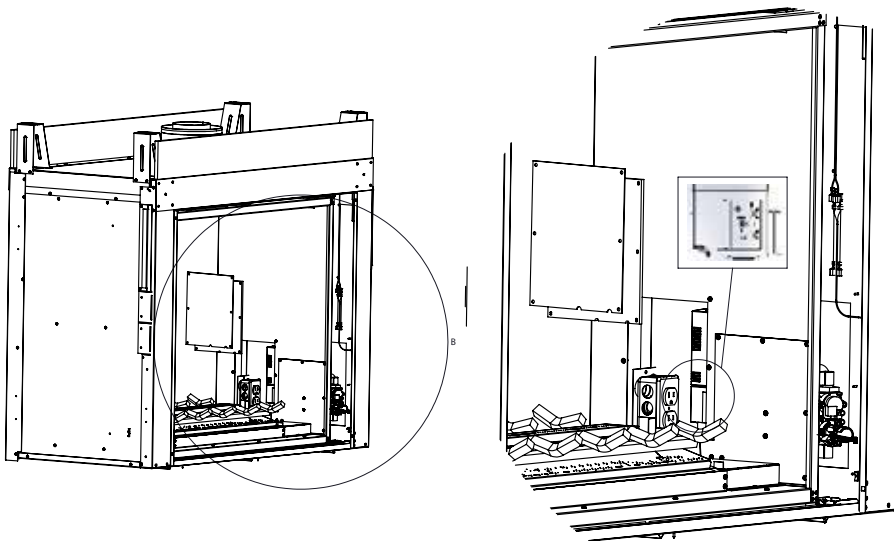

Figure 7

16. Reconnect wiring. Carefully slide valve back into firebox. Replace mounting screws.

Convert Control Box to New Gas Type

1. Access control box assembly by removing panel in right side of firebox. *Figure 7*. Take care of the wiring and gas lines.

2. To access the NG-LP switch gently remove conversion cap with small flat head screwdriver. Flip the switch from NG to LP and replace conversion cap.
3. Reinstall AC module and control box and access panel in reverse order of removal.

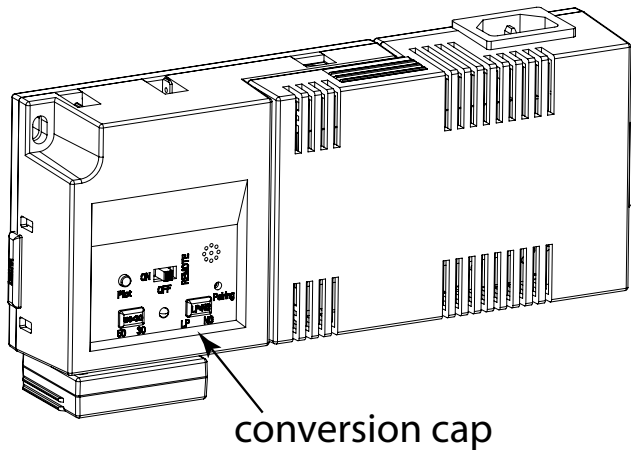

Figure 8

Testing Engine / Burner Assembly

1. Turn on the gas shut off valve.
2. Follow Lighting Instructions on the unit. Light the unit according to Homeowner's Manual. Use soapy water to check for leaks on the pilot assembly, regulator, burner and tubing. Turn off unit.
3. Place the Propane Conversion rating label plate and the regulator's conversion label on the existing rating plates. Attach conversion label to control valve.
4. Reinstall brick.
5. Reinstall logs, grate and embers. *Refer to Owner's Manual*
6. Reinstall glass door.
7. Light unit. Check for proper burner flame appearance. *Refer to Owner's Manual.*

DANGER

Never check for gas leak with open flame!