

Napoleon®
Electric
Fireplaces







Designer Features

EF39HD - Modern Elegance

A display of modern artwork and an elegant fireplace all in one. The EF39HD electric fireplace simply hangs on your wall like any artwork and plugs into a standard electrical outlet. Instantaneously, your room is easily transformed into a relaxing and intriguing retreat. Perfect for any room in a house, apartment, condo, office or spa. The EF39 offers you the most versatility options, limited only by your imagination.

Napoleon® Exclusive Features

- Specifically designed for an "eye-level" location, perfect for above a couch or beneath a flat screen TV
- Exclusive CRYSTALINE™ ember bed sparkles with modern elegance
- 5000 BTU's / 1500 Watts
- Easy installation... simply hang, plug in and enjoy
- Modern artwork design with elegant glass front
- Sleek 7" depth for flush wall hanging
- Comes complete with a convenient remote, turning the fireplace on & off and also controlling the ember bed intensity & heater
- Easily accessible on/off switch
- Go Green with Napoleon® - no emissions, no pollution, 100% energy efficient

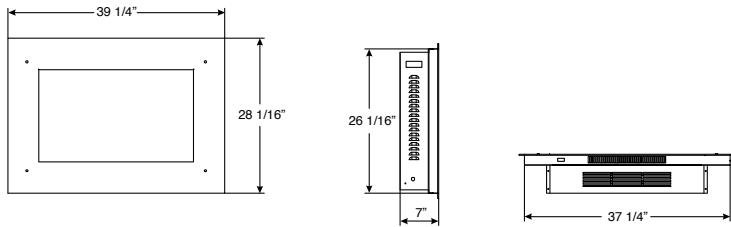

Model	BTU'S	Watts	Height		Front Width		Depth		Mobile Home Certified	Blower
			Actual	Framing	Actual	Framing	Actual	Framing		
EF39	5,000	1500	28 1/16"	N/A	39 1/4"	N/A	7"	N/A	Yes	Standard



Napoleon's Exclusive CRYSTALINE™ Ember Bed



Remote Control

Hand-held remote control comes standard



EF30 shown in drywall installation



Designer Options

EF30 - Clean Face Electric Fireplace

A clean face modern electric fireplace that looks great in both a mantel or drywall installation! The superior flame image and natural looking log set truly reflects the appearance of a real burning fire. Tinted reflection panels give the illusion of a deeper, larger firebox. The three stage heater and WHISPER QUIET™ fan, which can be conveniently thermostatically controlled, provides a warm, comfortable environment.



Available with realistic log ember bed...



... or available with Napoleon's exclusive CRYSTALINE™ ember bed

Napoleon® Exclusive Features

- Available as a firebox only or complete with a mantel package
- Two models to choose from - exclusive CRYSTALINE™ ember bed (EF30G) or realistic burning logs (EF30)
- 5000 BTU's/1500 watts
- Easy installation in both a mantel or in drywall
- Offers an open view of the fire with it's luxurious pewter finish and modern frame design
- Tinted reflective panels give the illusion of a deeper, larger firebox
- Adjustable ember bed and flame control
- 3 stage WHISPER QUIET™ fan and heater with thermostatic control keeps your comfort level exactly where you want it
- Easy access on/off switch
- Comes complete with a convenient remote that controls (with 7 different adjustments) the flame appearance, the ember bed intensity as well as the three stages of the heater output
- Operating with or without heat allows you to enjoy your fireplace all year round
- Prewired for optimal wall mount thermostat installation
- Four extra light bulbs are included
- Perfect for any room in a house, apartment, condo, office or spa
- Go Green with Napoleon® - no emissions, no pollution, 100% energy efficient

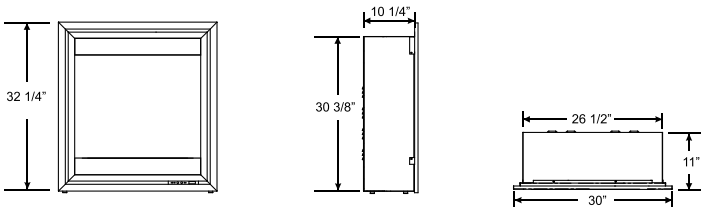

Model	BTU'S	Watts	Height		Front Width		Depth		Mobile Home Certified	Blower
			Actual	Framing	Actual	Framing	Actual	Framing		
EF30	5,000	1500	32 1/4"	31 1/2"	30"	29"	11"	11 3/4"	Yes	Standard
EF30G	5,000	1500	32 1/4"	31 1/2"	30"	29"	11"	11 3/4"	Yes	Standard

Mantels



EF30 bevelled mantel available in black



EF30 Metro™ mantel available in black and natural finishes



Remote Control

Hand-held modulating thermostatic remote control comes standard

Designer Options

TECHNOLOGY
ENERGY
EFFICIENT

Door Kits



Hammertone Pewter operating doors

Cabinet Packages

Flat wall units available in birch, light oak and painted black finishes



Painted black finish



Birch finish



Corner units available in birch, and light oak (shown) finishes

Remote Control



Optional plug-in hand-held remote control



EF31 Shown in custom stone mantel

Casaloma™ EF31 - The Complete Package

The Casaloma™ electric fireplace imitates the look of a traditional masonry fireplace but with all the convenience of simply plugging it in, sitting back and enjoying the radiant glow! Napoleon's patented Flamation™ technology randomly adjusts the flame effect, height & speed creating the illusion of a true wood burning fire. Finely detailed Phazer® logs, glass front and flush face design add to the traditional masonry look and feel. Available as a single unit or complete with a cabinet package in flat wall or corner style. An irresistible choice for any house, condo or apartment.

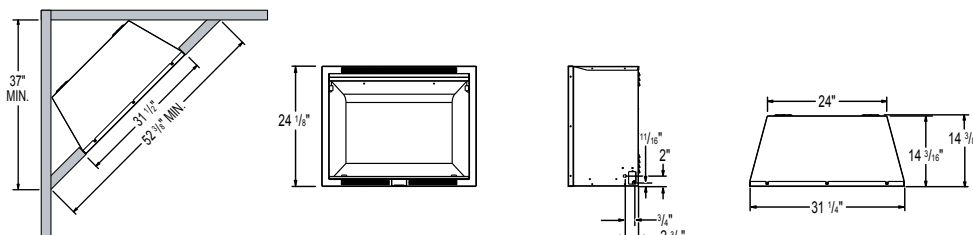

Model	BTU'S	Watts	Height		Front Width		Depth		Mobile Home Certified	Blower
			Actual	Framing	Actual	Framing	Actual	Framing		
EF31	5,000	1500	24 1/8"	24 3/4"	31 1/4"	31 1/2"	14 3/16"	14 3/8"	Yes	Standard

Certified under Canadian and American National Standards CSA C2.22/UL 1278



Shown with black cast iron surround and painted black louvres in drywall installation



Shown with webbed arched door and painted black louvres with mantel in mahogany



EF36 Shown with bay front, 24 karat gold plated ornamental insets

Designer Options



Trims

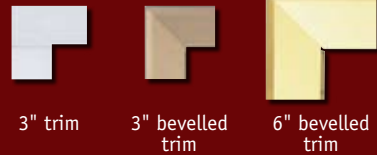

3" trim

3" bevelled trim

6" bevelled trim

Louvres

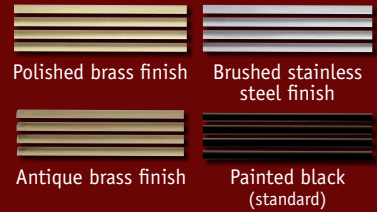

Polished brass finish

Brushed stainless steel finish

Antique brass finish

Painted black (standard)

Ornamental Insets



Heritage

Diamond

Eclipse

Seashell

Gothic

Cast Iron Surround



Porcelain Majolica Brown

Porcelain Black

Painted Black

Porcelain Majolica Green

Remote Control



Convenient hand-held remote control comes standard

EF36 - Thousands of designer options

The EF36 offers safe, easy installation in minutes creating endless design possibilities for any room. It arrives complete with flush black louvres and pull screen. Patented FLAMATION® technology and a unique design randomly adjusts the flame effect, height and speed creating the illusion of a true wood burning fire. The EF36 offers dozens of decorative options including louver overlays, a bay front, bevelled trim kits, bay louver kits, ornamental insets, trim kits, decorative door kits and cast iron surrounds. The convenient option of operating with or without heat allows you to enjoy your fireplace all year round.

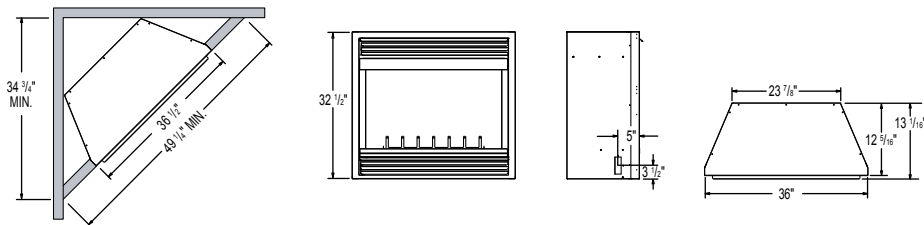

Model	BTU'S	Watts	Height		Front Width		Depth		Mobile Home Certified	Blower
			Actual	Framing	Actual	Framing	Actual	Framing		
EF36	5,000	1500	32 1/4"	31 1/2"	30"	29"	11"	11 3/4"	Yes	Standard

Certified under Canadian and American National Standards CSA C2.22/UL 1278

Experience Napoleon's Impressive Product Selection Online

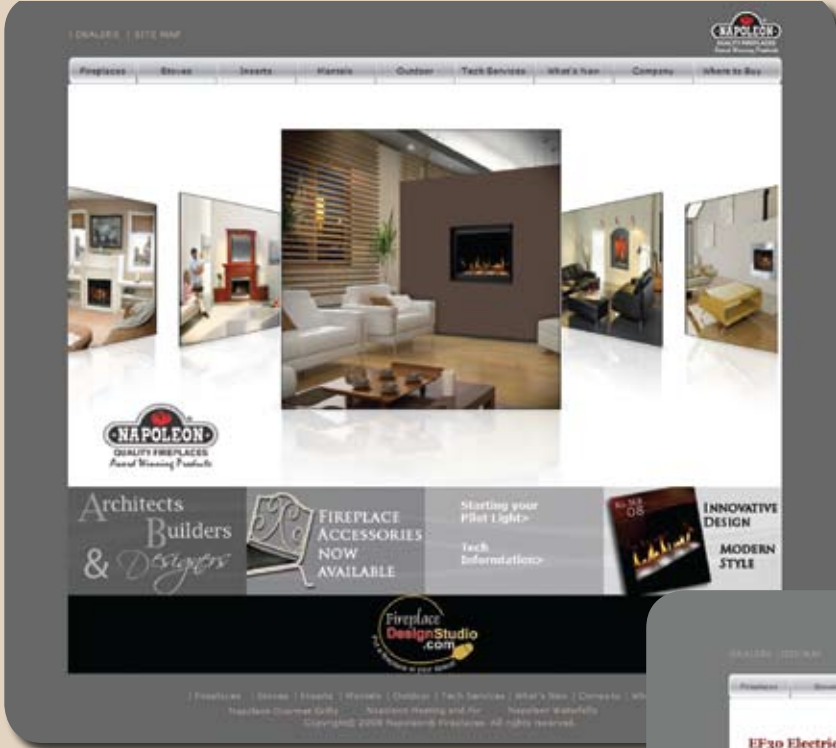

Please visit our website, www.napoleonfireplaces.com for more information on our complete line of wood, gas, oil and electric fireplaces, stoves and inserts as well as the Napoleon® Waterfall collection. Click "Where to Buy" to find the dealer nearest you.

We also have a complete line of outdoor living products including outdoor gas fireplaces, patio heaters, an outdoor gas firepit and gourmet gas grills.

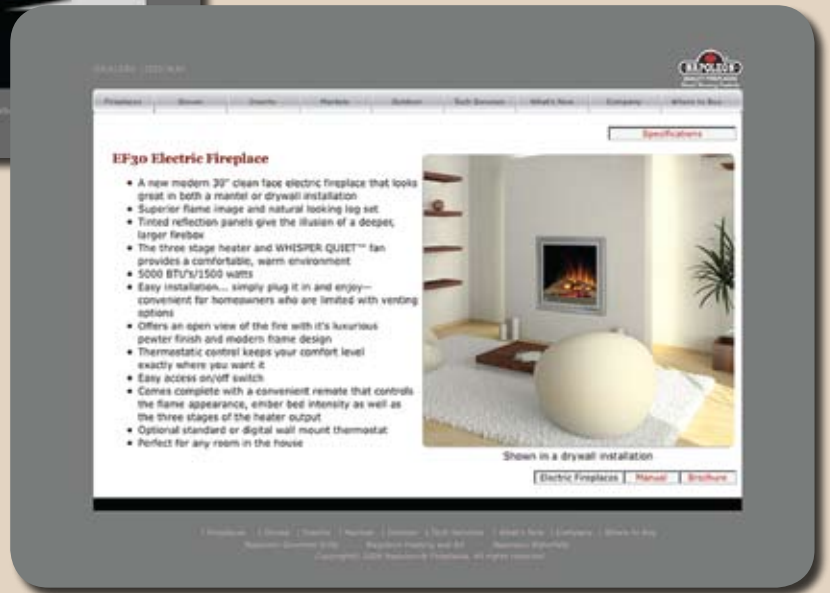

Other Napoleon® Products



Fireplace Inserts



Outdoor Living Products



Wood Burning Fireplaces



Cast Iron Gas Stoves



Waterfall Collection



Vent Free Fireplaces



Modern Collection



Direct Vent Fireplaces



Gourmet Gas Grills

Consult your owner's manual for complete installation instructions, accurate framing dimensions and proper clearances to combustible material. Check all local and national building codes and gas regulations. All specifications are subject to change without prior notice due to on-going product improvements. Products may not be exactly as shown. Napoleon® is a registered trademark of Wolf Steel Ltd. Patent U.S. 5.307.801, 75054- Can. 2.073.411, 2.082.915, 74589 © Wolf Steel Ltd.



• 103 Miller Drive, Crittenden, Kentucky, USA 41030
 • 24 Napoleon Road, Barrie, Ontario, Canada L4M 4Y8
 • 7200 Trans Canada Highway, Montreal, Quebec, Canada H4T 1A3
 Tel: 705-721-1212 Fax 705-722-6031
www.napoleonfireplaces.com
www.fireplacedesignstudio.com

Authorized Dealer

